

# EAGLE LAKE I.R. NO. 27

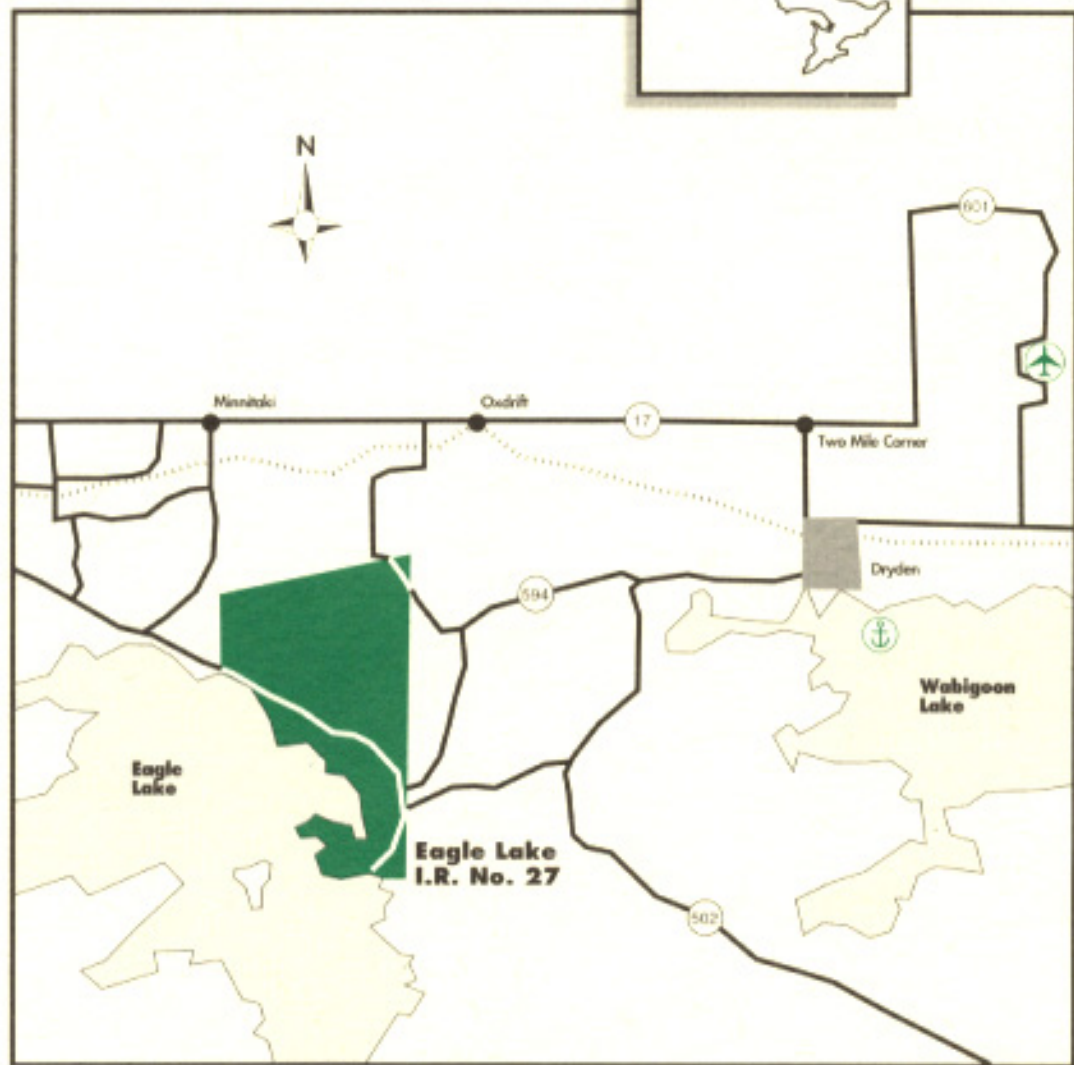

**Access:** reserve is approximately 15 km west of Dryden on Hwy. 594

- |   |         |   |                  |
|---|---------|---|------------------|
|  | Airport |  | Seaplane base    |
|  | Highway |  | Reserve land     |
|  | Railway |  | Urban settlement |